

T 24 S. R 15 E M Wm

51 A	1	2	3	4	5	6	7	8	9	10	11	12	13	14	15	16	17	18	19	20	21	22	23	24	25
52 B	+	+	+			+	+			+	+	+		+	+	+		+	+	+		+	+	+	
53 C	+	6	+			+	5	+		+	4	+		+	3	+		+	2	+		+	1	+	
54 D	+	+	+							+	+	+		+	+	+		+	+	+		+	+	+	
55 E	+																								
56 F	+	+	+			+	+			+	+	+		+	+	+		+	+	+		+	+	+	
57 G	+	7	+			+	8	+		+	9	+		+	10	+		+	11	+		+	12	+	
58 H	+	+	+			+	+			+	+	+		+	+	+		+	+	+		+	+	+	
59 J	+																								
60 K	+	+	+			+	+			+	+	+		+	+	+		+	+	+		+	+	+	
61 L	+	18	+			+	17	+		+	16	+		+	15	+		+	14	+		+	13	+	
62 M	+	+	+			+	+			+	+	+		+	+	+		+	+	+		+	+	+	
63 N	+																								
64 O	+	+	+			+	+			+	+	+		+	+	+		+	+	+		+	+	+	
65 P	+	19	+			+	20	+		+	21	+		+	22	+		+	23	+		+	24	+	
66 Q	+	+	+			+	+			+	+	+		+	+	+		+	+	+		+	+	+	
67 R	+																								
68 S	+	+	+			+	+			+	+	+		+	+	+		+	+	+		+	+	+	
69 T	+	30	+			+	29	+		+	28	+		+	27	+		+	26	+		+	25	+	
70 J	+	+	+			+	+			+	+	+		+	+	+		+	+	+		+	+	+	
71 V	+																								
72 W	+	+	+			+	+			+	+	+		+	+	+		+	+	+		+	+	+	
73 X	+	31	+			+	32	+		+	33	+		+	34	+		+	35	+		+	36	+	
74 Y	+	+	+			+	+			+	+	+		+	+	+		+	+	+		+	+	+	
75 Z	+																								

LEGEND

○ = Corner having information on form 5680-2 in this file.

FILING INSTRUCTION

File 5680-2 card record by letter and number coordinates behind the file guide for the township in which it falls.

File the 5680-2 card record by letter and then by number i.e., all A cards first, then B cards etc.

The first card behind the file guide (if data have been obtained and recorded) will be card A-1 for N.W. Township Corner, then card A-2 for 1/16 corner then card A-3 for 1/4 corner etc.

Index
File No. 2351

CORNER RECORD (SEARCH)
(Ref. FSM 7151.4)

Contract or
Survey No. 000832 Cgr.
No. A-23

T 24 S. R. 15 E. R.D. Ft. Rock County Lake N/4 Cor. of
Merid. WILLAMETTE N.F. DESCHUTES State OREGON Section 1

SEE: Z-23 T. 23 S., R. 15 E., W.M.

BCSP

Index File No. _____ CORNER RECORD (SEARCH) (Ref. FSM 7151.4) Tract or Survey No. _____ Cor. No. J-1

T 295 R. 15E R.D. Blm County Lake

Merid. Wil N.F. _____ State OR

CORNER DIAGRAM

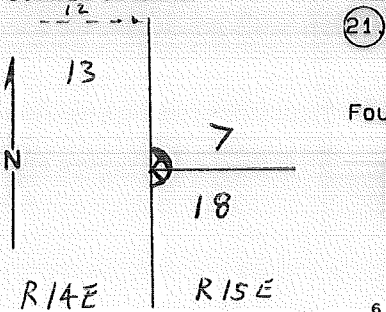

DESCRIBE CORNER MONUMENT FOUND

(21) GLO Record - Set a Basalt Stone, 12x12x4 ins., 8 ins. in the ground for Closing Cor. of Secs. 7 & 18, marked C.C. on E. with 2 grooves on N. and 4 grooves on S. faces and raised a mound of Stone, 4 ft. base, 2 ft. high, S. of Cor. Pits impracticable.
 Found - Original stone as described, clearly marked.
 Location tag on Juniper approx. 20 ft. East of corner.

DESCRIBE BEARING TREES OR OTHER OFFICIAL ACCESSORIES FOUND

PHOTO IDENTIFICATION DATA

Photo No. _____
 Filed At. _____
 Object Ident. _____
 Ident. By _____
 Signature _____

DESCRIBE CORNER LOCATION RELATIVE TO NEAR-BY FEATURES, ALSO HOW TO REACH CORNER

PLANE COORDINATE POSITION DATA

State _____ Zone _____
 X _____
 Y _____
 Estab. By _____
 Agency _____

Signature W Ham Title _____ Division _____ Headquarters _____ Date 9/95 FS-7100-52 (3/68)

Index
File No. _____

CORNER RECORD (SEARCH)

(Ref. FSM 7151.4)

Tract or Survey No. _____
Cor. No. N-1

T 245 R. 15E R.D. BLM County Lake
Merid. W1 N.F. _____ State OR

CORNER DIAGRAM

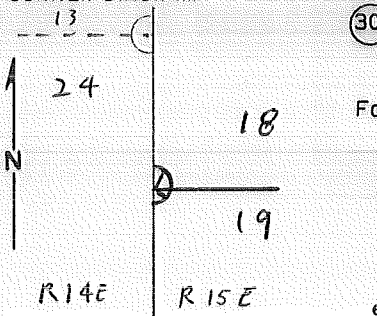

DESCRIBE CORNER MONUMENT FOUND

30 GLO Record - Set a Lava Stone, 14x10x9 ins., 9 ins. in the ground for Closing Cor. of Secs. 18 & 19, marked C.C. on E. with 3 grooves on N. and S. faces and raised a mound of Stone, 2 ft. base, 1 1/2 ft. high E. of Cor. Pits impracticable.
Found - Original stone as described, clearly marked.
Set steel fence post 3 ft. North of corner.

DESCRIBE BEARING TREES OR OTHER OFFICIAL ACCESSORIES FOUND

PHOTO IDENTIFICATION DATA

Photo No. _____
Filed At. _____
Object Ident. _____
Ident. By _____
Signature

DESCRIBE CORNER LOCATION RELATIVE TO NEAR-BY FEATURES, ALSO HOW TO REACH CORNER

PLANE COORDINATE POSITION DATA

State _____ Zone _____
X _____
Y _____
Estab. By _____
Agency

Signature _____ Title _____ Division _____ Headquarters _____ Date _____ FS-7100-52 (3/68)